

8" MINIMUM, OVER 8" DEEP
12" MINIMUM UP TO 6'
FROM TOP OF CURB

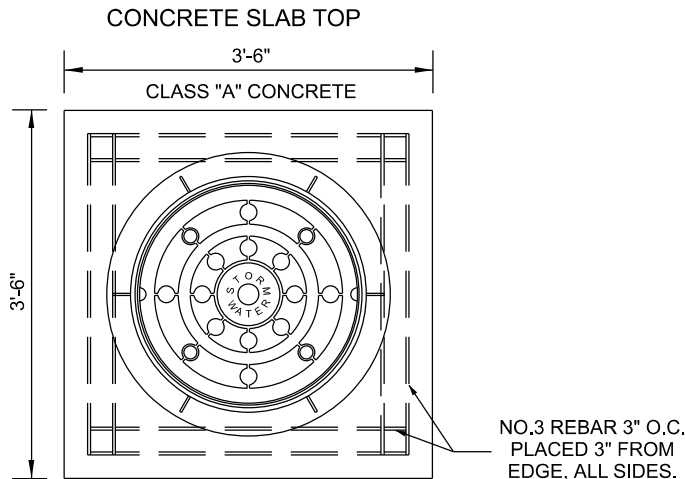

NOTES:

1. FOR 24" PIPE & LARGER USE PIPE DIAMETER PLUS 12" FOR MINIMUM INSIDE DIMENSION.
2. USE 4" X 4" X 8" OR 4" X 8" X 16" SOLID CONCRETE BLOCK. CAST IN PLACE OR PRECAST CONCRETE TO MEET NCDOT STANDARDS ACCEPTABLE.
3. STEPS SHALL BE INSTALLED IN JUNCTION BOXES OVER 3' IN DEPTH. DEPTH SHALL BE MEASURED FROM THE TOP OF GRATE TO THE INVERT OF THE JUNCTION BOX.

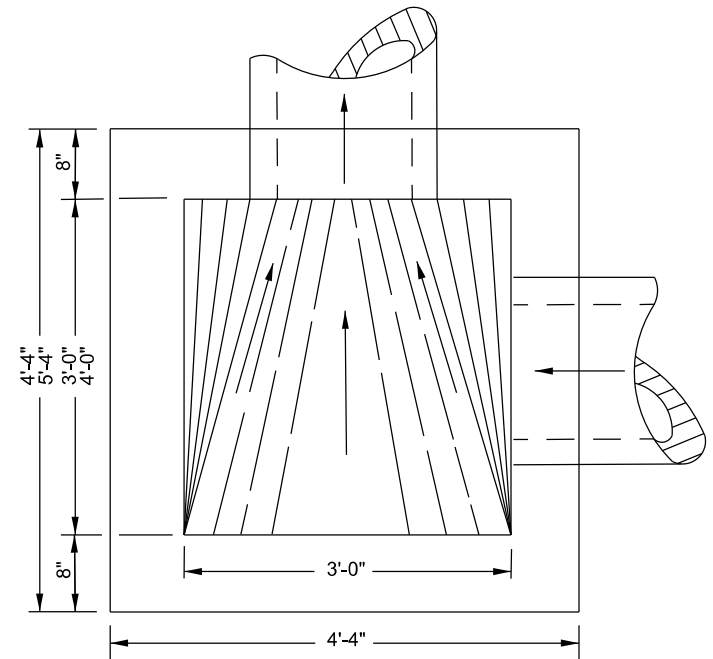

STANDARD JUNCTION BOX

TOWN OF GARNER, N.C.

DESIGNED BY:

TOG

APPROVED BY:

CSJ

REVISED
FEB. 2022

STD. NO.
SW-1.02